

TITLE OF THE PROJECT

DEVELOPMENT OF SRI SRI  
MAHA PURUSH ANIRUDHADEVA'S  
JANMAKSHETRA AT NARAYANPUR

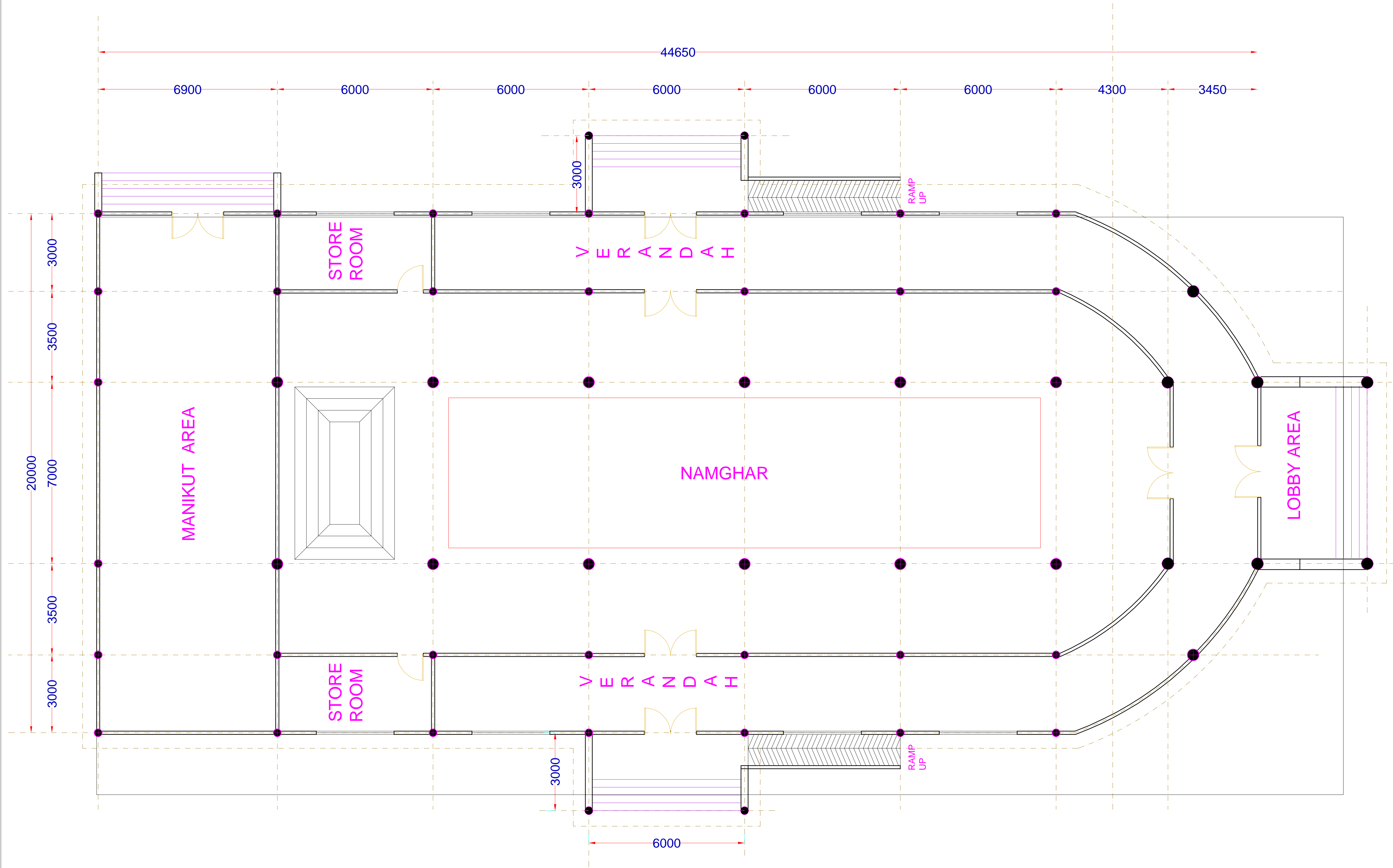

BORNAMGHAR

GROUND FLOOR PLAN

AREA: 925.90 SQM

DRW.No.2023/DS/A/BN-01

NOTE:

ALL DIMENSIONS ARE IN MM

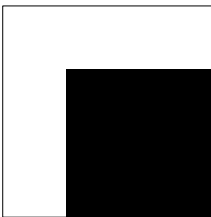

CONSULTANT

DESIGNERS HIVE

ARCHITECTS &  
ENGINEERS.

ZOO ROAD, JONALI, GUWAHATI-24